



TECTUL

UNIÓN RÍGIDA RANURADA REDUCIDA

CARACTERÍSTICAS

APLICACIONES



MATERIALES

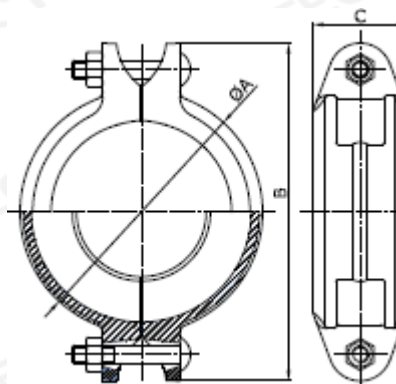

* Vista de sección transversal de tipo informativa. No representa versión específica en la Unión.

CARACTERÍSTICAS



Permite reducir de forma directa la sección de paso del tubo con ahorro de accesorios. Presiones de trabajo hasta 300 PSI.

MATERIALES



Fundición de hierro dúctil conforme ASTM a-536. Grado 65-45-12.

APLICACIONES



Ideales para redes contraincendios.

DATOS TÉCNICOS

MEDIDA	DIAMETRO EXTERIOR EN TUBERÍA [mm]	DIAMETRO UNIÓN RÍGIDA [mm] (Ø)	LONGITUD [mm] (B)	ANCHO [mm] (C)	PESO [g]
2"x1-1/2"	60,30*x48,30*	90,00*	129,00*	47,00*	960,00*
2-1/2"x2"	76,10*x60,30*	101,00*	137,00*	48,00*	230,00*
3"x2"	88,90*x60,30*	120,00*	164,00*	48,00*	300,00*
3"x2-1/2"	88,90*x76,10*	120,00*	164,00*	48,00*	330,00*
4"x2"	114,30*x60,30*	150,00*	195,00*	49,00*	560,00*
4"x2-1/2"	114,30*x76,10*	150,00*	195,00*	49,00*	950,00*
4"x3"	114,30*x88,90*	150,00*	195,00*	49,00*	1150,00*
6"x4"	168,30*x114,30*	203,00*	235,00*	50,00*	1850,00*
8"x6"	219,10*x168,30*	264,00*	313,00*	60,00*	4100,00*

* Fotos y medidas referenciales, sujetas a cambios sin previo aviso por parte del proveedor o fabricante.



TECTUL

REDUCED RIGID GROOVED JOINT

APPLICATIONS



CHARACTERISTICS



MATERIALS

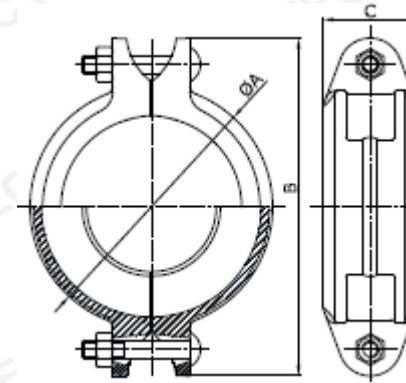

* Informational type cross section view. It does not represent a specific version on the Joint.

CHARACTERISTICS



It allows direct reduction of the section of passage of the tube with saving of accessories.
Working pressures up to 300 PSI.

MATERIALS



ASTM compliant ductile iron casting a-536. Grade 65-45-12.

APPLICATIONS



Ideal for fire networks.

TECHNICAL DATA

MEASURE	PIPE EXTERNAL DIAMETER [mm]	RIGID COUPLING DIAMETER [mm] (Ø)	LENGHT [mm] (B)	WIDTH [mm] (C)	WEIGHT [g]
2"x1-1/2"	60,30*x48,30*	90,00*	129,00*	47,00*	960,00*
2-1/2"x2"	76,10*x60,30*	101,00*	137,00*	48,00*	230,00*
3"x2"	88,90*x60,30*	120,00*	164,00*	48,00*	300,00*
3"x2-1/2"	88,90*x76,10*	120,00*	164,00*	48,00*	330,00*
4"x2"	114,30*x60,30*	150,00*	195,00*	49,00*	560,00*
4"x2-1/2"	114,30*x76,10*	150,00*	195,00*	49,00*	950,00*
4"x3"	114,30*x88,90*	150,00*	195,00*	49,00*	1150,00*
6"x4"	168,30*x114,30*	203,00*	235,00*	50,00*	1850,00*
8"x6"	219,10*x168,30*	264,00*	313,00*	60,00*	4100,00*

* Reference photos and measurements, subject to change without prior notice from the supplier or manufacturer.