



# TECTUL

## BUJE - CLASE 150

### MATERIALES

### CARACTERÍSTICAS FÍSICAS

### CARACTERÍSTICAS DIMENSIONALES

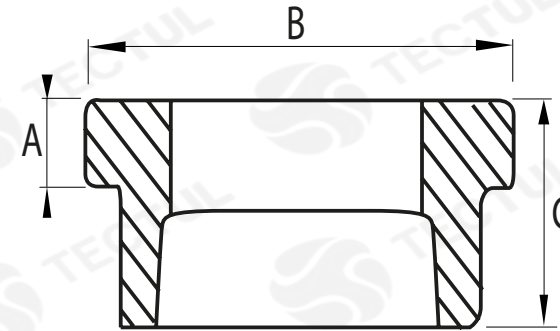
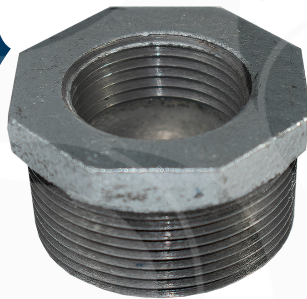

\* Vista de sección transversal de tipo informativa. No representa una versión específica del accesorio o elemento.

### DATOS TÉCNICOS

MEDIDA	ANCHO ENTRE CARAS PLANAS [mm] (A)	ANCHO ENTRE ARISTAS [mm] (B)	ALTURA [mm] (C)	PESO [g]	MEDIDA	ANCHO ENTRE CARAS PLANAS [mm] (A)	ANCHO ENTRE ARISTAS [mm] (B)	ALTURA [mm] (C)	PESO [g]
3/8" X 1/4"	18,00*	21,00*	21,00*	17*	2" x 1"	50,00*	73,00*	35,00*	285*
1/2" X 3/8"	23,00*	27,00*	25,00*	31*	2" x 1-1/4"	64,00*	73,00*	35,00*	334*
1/2" x 1/4"	23,00*	26,00*	25,00*	35*	2" x 1-1/2"	65,00*	73,00*	35,00*	276*
3/4" X 1/4"	30,00*	34,00*	25,00*	71*	2-1/2" x 1-1/4"	82,00*	83,00*	41,00*	467*
3/4" x 1/2"	30,00*	34,00*	27,00*	51*	2-1/2" x 1-1/2"	77,00*	83,00*	41,00*	552*
3/4" X 3/8"	30,00*	34,00*	22,00*	61*	2-1/2" x 2"	77,00*	83,00*	42,00*	445*
1" x 1/2"	37,00*	42,00*	30,00*	105*	3" x 1"	87,75*	103,00	47,00*	634*
1" x 3/8"	29,00*	42,00*	25,00*	95*	3" x 1-1/4"	87,85*	103,00*	44,00*	680*
1" x 3/4"	37,00*	42,00*	30,00*	81*	3" x 1-1/2"	87,90*	103,00*	44,00*	713*
1-1/4" x 3/8"	30,00*	53,00*	30,00*	146*	3" x 2"	96,00*	103,00*	45,00*	908*
1-1/4" x 1/2"	46,00*	53,00*	32,00*	191*	3" x 2-1/2"	101,00*	108,00*	48,00*	825*
1-1/4" x 3/4"	46,00*	52,00*	30,00*	161*	4" x 1"	102,00*	130,00*	53,00*	1227*
1-1/4" x 1"	41,00*	52,00*	30,00*	130*	4" x 1-1/2"	102,80*	130,00*	48,50*	1235*
1-1/2" x 1/2"	35,00*	58,00*	32,00*	141*	4" x 2"	113,00*	130,00*	49,50*	1225*
1-1/2" x 3/4"	51,00*	58,00*	36,00*	221*	4" x 2-1/2"	113,10*	130,00*	50,00*	1360*
1-1/2" x 1"	51,00*	58,00*	32,00*	215*	4" x 3"	121,60*	130,00*	50,00*	1389*
1-1/2" x 1-1/4"	52,00*	58,00*	32,00*	149*	6" x 3"	165,00*	165,00*	60,00*	2740*
2" x 1/2"	35,00*	73,00*	35,00*	239*	6" x 2"	165,00*	168,00*	57,35*	2705*
2" x 3/4"	44,00*	73,00*	35,00*	272*	6" x 4"	165,00*	168,00*	57,35*	2863*

\* Fotos y medidas referenciales, sujetas a cambios sin previo aviso por parte del proveedor o fabricante.



### MATERIALES

Fabricado en hierro maleable galvanizado. Recubierto ASTM A-197 ASTM A153 HOT-DIP (Caliente)



### CARACTERÍSTICAS FÍSICAS

Cumple con los estándares de diseño ANSI/ASME B16.3 y B16.14. Extremos reforzados y estándar UL/FM



### CARACTERÍSTICAS DIMENSIONALES

Dimensiones básicas según la Norma Nacional estadounidense. Con conexión roscada NPT según ANSI/ASME B1.20.1



# TECTUL

# BUSHING - CLASS 150

## MATERIALS

## PHYSICAL CHARACTERISTICS

## DIMENSIONAL CHARACTERISTICS

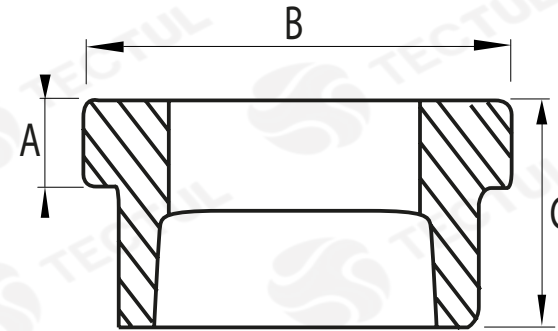
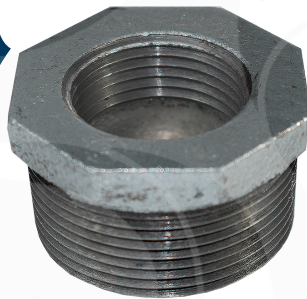

\* Informational cross-sectional view. Does not represent a specific version of the accessory or item.

**MATERIALS**  
 Made of galvanized malleable iron  
 Coated ASTM A-197  
 ASTM A153 HOT-DIP (Hot)

**PHYSICAL CHARACTERISTICS**  
 Meets design standards  
 ANSI/ASME B16.3 and B16.14.  
 Reinforced ends and UL/FM standard

**DIMENSIONAL CHARACTERISTICS**  
 Basic dimensions according to the Standard  
 National American. With threaded  
 connection NPT per ANSI/ASME B1.20.1

TECHNICAL DATA									
MEASURE	WIDTH BETWEEN FLAT SIDES [mm] (A)	WIDTH BETWEEN EDGES [mm] (B)	HEIGHT [mm](C)	WEIGHT [g]	MEASURE	WIDTH BETWEEN FLAT SIDES [mm] (A)	WIDTH BETWEEN EDGES [mm] (B)	HEIGHT [mm](C)	WEIGHT [g]
3/8" X 1/4"	18,00*	21,00*	21,00*	17*	2" x 1"	50,00*	73,00*	35,00*	285*
1/2" X 3/8"	23,00*	27,00*	25,00*	31*	2" x 1-1/4"	64,00*	73,00*	35,00*	334*
1/2" x 1/4"	23,00*	26,00*	25,00*	35*	2" x 1-1/2"	65,00*	73,00*	35,00*	276*
3/4" X 1/4"	30,00*	34,00*	25,00*	71*	2-1/2" x 1-1/4"	82,00*	83,00*	41,00*	467*
3/4" x 1/2"	30,00*	34,00*	27,00*	51*	2-1/2" x 1-1/2"	77,00*	83,00*	41,00*	552*
3/4" X 3/8"	30,00*	34,00*	22,00*	61*	2-1/2" x 2"	77,00*	83,00*	42,00*	445*
1" x 1/2"	37,00*	42,00*	30,00*	105*	3" x 1"	87,75*	103,00*	47,00*	634*
1" x 3/8"	29,00*	42,00*	30,00*	95*	3" x 1-1/4"	87,85*	103,00*	44,00*	680*
1" x 3/4"	37,00*	42,00*	30,00*	81*	3" x 1-1/2"	87,90*	103,00*	44,00*	713*
1-1/4" x 3/8"	30,00*	53,00*	30,00*	146*	3" x 2"	96,00*	103,00*	45,00*	908*
1-1/4" x 1/2"	46,00*	53,00*	32,00*	191*	3" x 2-1/2"	101,00*	108,00*	48,00*	825*
1-1/4" x 3/4"	46,00*	52,00*	30,00*	161*	4" x 1"	102,00*	130,00*	53,00*	1227*
1-1/4" x 1"	41,00*	52,00*	30,00*	130*	4" x 1-1/2"	102,80*	130,00*	48,50*	1235*
1-1/2" x 1/2"	35,00*	58,00*	32,00*	141*	4" x 2"	113,00*	130,00*	49,50*	1225*
1-1/2" x 3/4"	51,00*	58,00*	36,00*	221*	4" x 2-1/2"	113,10*	130,00*	50,00*	1360*
1-1/2" x 1"	51,00*	58,00*	32,00*	215*	4" x 3"	121,60*	130,00*	50,00*	1389*
1-1/2" x 1-1/4"	52,00*	58,00*	32,00*	149*	6" x 3"	165,00*	165,00*	60,00*	2740*
2" x 1/2"	35,00*	73,00*	35,00*	239*	6" x 2"	165,00*	168,00*	57,35*	2705*
2" x 3/4"	44,00*	73,00*	35,00*	272*	6" x 4"	165,00*	168,00*	57,35*	2863*

\* Reference photos and measurements, subject to change without prior notice from the supplier or manufacturer.