



TECTUL

TAPÓN HEMBRA - CLASE 300

MATERIALES

CARACTERÍSTICAS FÍSICAS



CARACTERÍSTICAS DIMENSIONALES

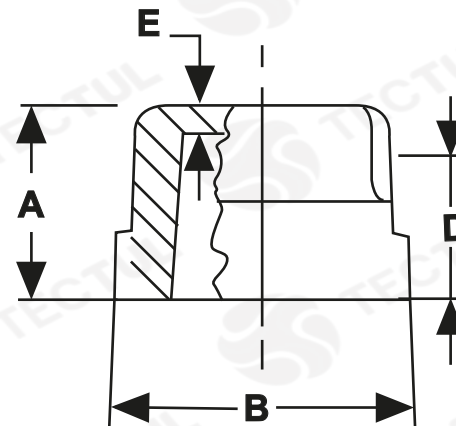

* Vista de sección transversal de tipo informativa. No representa una versión específica del accesorio o elemento.

DATOS TÉCNICOS

MEDIDA	ALTURA [mm] (A)	ANCHO [mm] (B)	LONGITUD DE ROSCA [mm] (D)	ESPESOR [mm] (E)	PESO [g]
1/4"	19,80*	26,00*	10,93*	2,10*	43,60*
3/8"	21,10*	30,00*	11,93*	3,81*	63,50*
1/2"	24,90*	36,00*	14,47*	4,06*	103,00*
3/4"	27,50*	44,00*	16,25*	4,57*	160,20*
1"	32,00*	50,00*	19,05*	5,08*	250,00*
1 1/4"	35,00*	62,00*	21,33*	5,58*	388,30*
1 1/2"	36,30*	69,00*	22,09*	6,09*	501,30*
2"	42,70*	85,00*	25,40*	6,60*	811,50*
2 1/2"	52,40*	98,00*	29,71*	7,87*	1293,70*
3"	55,20*	117,00*	31,24*	8,89*	1944,60*
4"	63,00*	164,00*	36,20	11,68*	3297,70*

* Fotos y medidas referenciales, sujetas a cambios sin previo aviso por parte del proveedor o fabricante.

MATERIALES
Fabricados hierro maleable negro
ASTM A197/A197M

CARACTERÍSTICAS FÍSICAS
Con extremos reforzados. Recomendado para la conducción de aceites, petróleo, gases (GLP/GNV) y vapor

CARACTERÍSTICAS DIMENSIONALES
Dimensiones básicas según la Norma Nacional estadounidense. Con conexión roscada NPT según ANSI/ASME B1.20.1



TECTUL

CAP - CLASS 300

MATERIALS

PHYSICAL CHARACTERISTICS

DIMENSIONAL CHARACTERISTICS

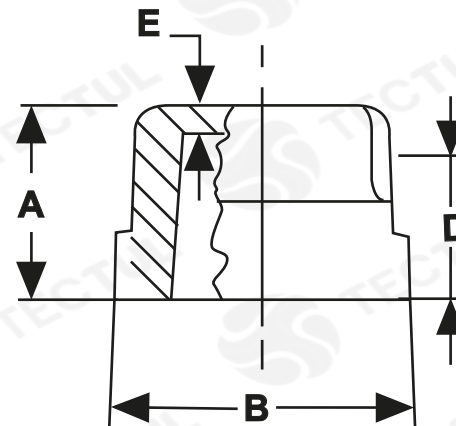

* Informational cross-sectional view. Does not represent a specific version of the accessory or item.

DATOS TÉCNICOS

MEASURE	HEIGHT [mm] (A)	WIDTH [mm] (B)	THREAD LENGTH [mm] (D)	THICKNESS [mm] (E)	WEIGHT [g]
1/4"	19,80*	26,00*	10,93*	2,10*	43,60*
3/8"	21,10*	30,00*	11,93*	3,81*	63,50*
1/2"	24,90*	36,00*	14,47*	4,06*	103,00*
3/4"	27,50*	44,00*	16,25*	4,57*	160,20*
1"	32,00*	50,00*	19,05*	5,08*	250,00*
1 1/4"	35,00*	62,00*	21,33*	5,58*	388,30*
1 1/2"	36,30*	69,00*	22,09*	6,09*	501,30*
2"	42,70*	85,00*	25,40*	6,60*	811,50*
2 1/2"	52,40*	98,00*	29,71*	7,87*	1293,70*
3"	55,20*	117,00*	31,24*	8,89*	1944,60*
4"	63,00*	164,00*	36,20	11,68*	3297,70*

* Reference photos and measurements, subject to change without prior notice from the supplier or manufacturer.

MATERIALS
Made of black malleable iron
ASTM A197/A197M

PHYSICAL CHARACTERISTICS
With reinforced ends. Recommended for the conduction of oils, petroleum, gases (LPG/NGV) and steam

DIMENSIONAL CHARACTERISTICS
Basic dimensions according to the Standard National American. With threaded connection NPT per ANSI/ASME B1.20.1