



# TECTUL

## ABRAZADERA OMEGA INOXIDABLE

### MATERIALES

#### CARACTERÍSTICAS FÍSICAS



#### CARACTERÍSTICAS DIMENSIONALES

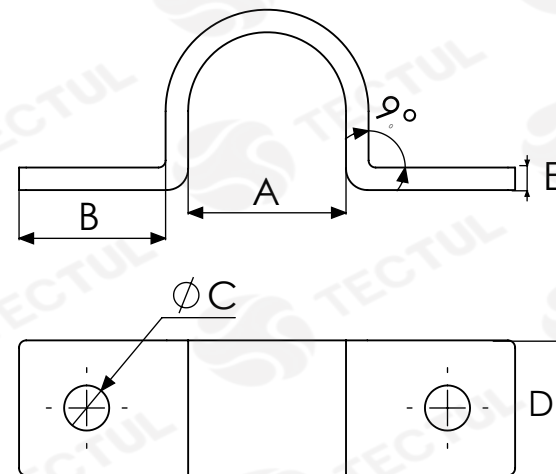

\* Vista de sección transversal de tipo informativa. No representa una versión específica del accesorio o elemento.

### MATERIALES

Las abrazaderas son usadas para soportar, instalar y sujetar tubería a superficie o estructura.

### CARACTERÍSTICAS FÍSICAS

Fabricado a partir de lámina inoxidable grado 304.

### CARACTERÍSTICAS DIMENSIONALES

Dimensiones básicas de acuerdo a la Norma Nacional estadounidense.

### DATOS TÉCNICOS

MEDIDA	DIÁMETRO DE TUBERÍA [mm] (A)	LONGITUD DE ALETA [mm] (B)	DIÁMETRO DE PERFORACIÓN [In] (C)	ANCHO [mm] (D)	ESPESOR DE LÁMINA [mm] (E)
1/2"	22,00*	19,63*	6,35*	19,00*	3,17*
3/4"	27,50*	20,63*	6,35*	19,00*	3,17*
1"	34,50*	21,40*	6,35*	25,40*	3,17*
1 1/4"	44,00*	27,00*	8,30*	25,40*	3,17*
1 1/2"	50,00*	26,70*	8,30*	25,40*	3,17*
2"	62,50*	30,60*	8,30*	25,40*	3,17*
2 1/2"	75,00*	34,20*	8,30*	25,40*	3,17*
3"	91,00*	37,30*	8,30*	25,40*	3,17*
4"	116,50*	37,30*	8,30*	25,40*	3,17*
6"	170,00*	40,00*	8,30*	25,40*	3,17*

\* Fotos y medidas referenciales, sujetas a cambios sin previo aviso por parte del proveedor o fabricante.



# TECTUL

# STAINLESS OMEGA CLAMP

## MATERIALS

## PHYSICAL CHARACTERISTICS

## DIMENSIONAL CHARACTERISTICS

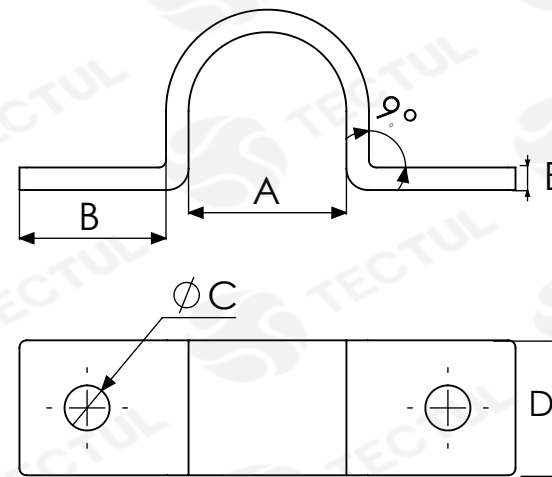

\* Informational type cross sectional view. It does not represent a specific version of the accessory or item.

## MATERIALS

Clamps are used to support, install and clamp pipe a surface or structure.

## PHYSICAL CHARACTERISTICS

Manufactured from foil 304 grade stainless.

## DIMENSIONAL CHARACTERISTICS

Basic dimensions according to American National Standard.

## TECHNICAL DATA

MEASURE	PIPE DIAMETER [mm] (A)	LENGHT OF FIN [mm] (B)	DIAMETER OF DRILLING [In] (C)	WIDTH [mm] (D)	THICKNESS OF SHEET [mm] (E)
1/2"	22,00*	19,63*	6,35*	19,00*	3,17*
3/4"	27,50*	20,63*	6,35*	19,00*	3,17*
1"	34,50*	21,40*	6,35*	25,40*	3,17*
1 1/4"	44,00*	27,00*	8,30*	25,40*	3,17*
1 1/2"	50,00*	26,70*	8,30*	25,40*	3,17*
2"	62,50*	30,60*	8,30*	25,40*	3,17*
2 1/2"	75,00*	34,20*	8,30*	25,40*	3,17*
3"	91,00*	37,30*	8,30*	25,40*	3,17*
4"	116,50*	37,30*	8,30*	25,40*	3,17*
6"	170,00*	40,00*	8,30*	25,40*	3,17*

\* Reference photos and measurements, subject to change without prior notice from the supplier or manufacturer.